

EINZELNE FÜHRUNG, AUSGESTATTET MIT 3 INNEN - AUßEN
 UMKEHRBAREN HARTEN BACKEN, SPANNSCHLÜSSEL UND...

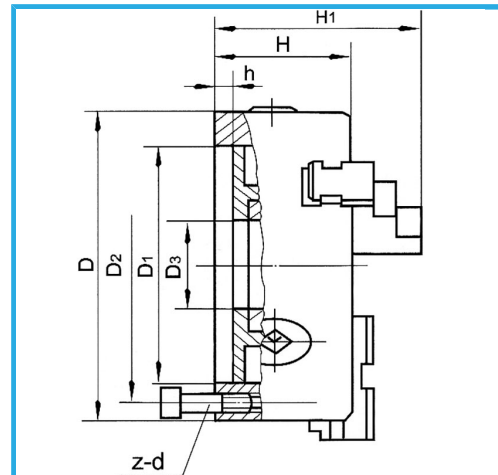

| | |
|--------------------------|-----------------|
| D1 | 206 mm |
| D2 | 226 mm |
| D3 | 80 mm |
| H1 | 136 mm |
| H | 80 mm |
| h | 5 mm |
| z-d | 3-M12 mm |
| Vierkantschlüssel | 12 mm |
| A - A1 | 6 - 110 mm |
| B - B1 | 80 - 250 mm |
| C - C1 | 90 - 250 mm |
| Nettogewicht | 23,4 kg |
| Bruttogewicht | 23,80 kg |
| Verpackungsmaße | 315x315x220h mm |
| EAN-Code | 8012667397296 |

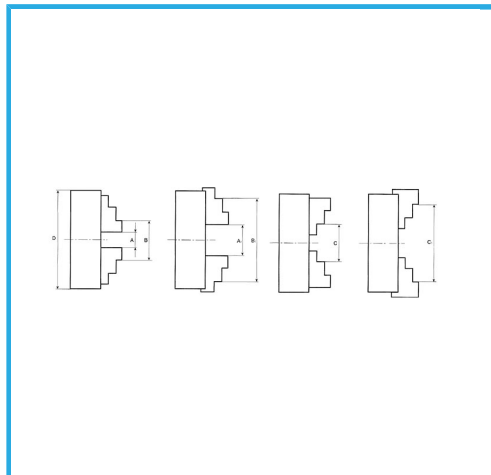

Box



Holzkasten



Gusseisen